

Data sheet - M4 WNPL 13

FLEXINUT - blind inserts large flat head - blind inserts, flanged neoprene bushing with a captive brass nut

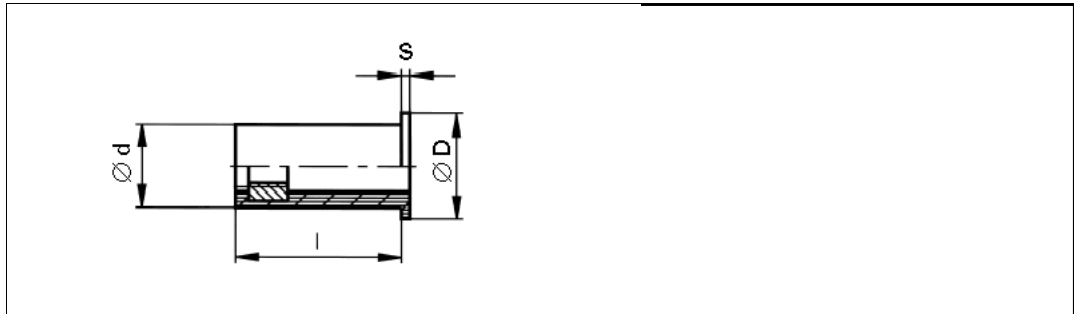

Order description	M4 WNPL 13
Thread	M4
Grip range K K	0.4-4.4 mm
Mounting hole-Ø +0,1	8.0 mm
Ø d	7.9 mm
Ø D	19.1 mm
S	1.5 mm
L	12.7 mm
Material	Neoprene bushing plus captive brass nut
Special features	assembling without tools, only standard machine screws fastens in blind, burr-free holes suitable for closed end holes dampens shock and vibration dielectric

uniform resource locator: